



The PS-EFP system is designed to provide most cost-effective solution of power and data connection such as video and communication between the camera and the CCU with standard single-mode optical fiber which can be up to 10km.

When combined with the PS-EFP-B base station adapter and PS-EFP-C camera adapter, cameras can be remotely deployed using the ordinary single-mode optical fiber network that may exist within a stadium, campus or other outside broadcast.

Features

- Eliminate interference and grounding problems, saving the weight and cost of laying cables
- Use ordinary fiber optic connectors to connect cameras and CCUs through existing fiber optic infrastructure, or temporary field fiber optic cables
- The system supports the standard camera power supply protocol, which enables the camera and the CCU to activate of the optical transceiver inside, and establish a real connection between them with ordinary single-mode optical fiber
- The power supply unit can supply power to the camera through a standard SMPTE cable up to 1.5 km, and the power can meet the 4K and HD cameras installed with box lenses and other high-power accessories
- It can keep the ENG call function when the optical fiber is kept connected, while the camera is powered off and the CCU is powered on

System Configuration

Configuration 1
Camera powered by SMPTE cable

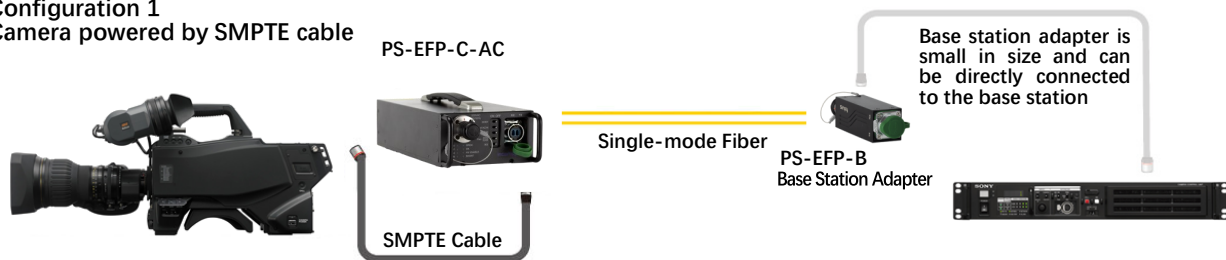

Configuration 2
Camera powered locally

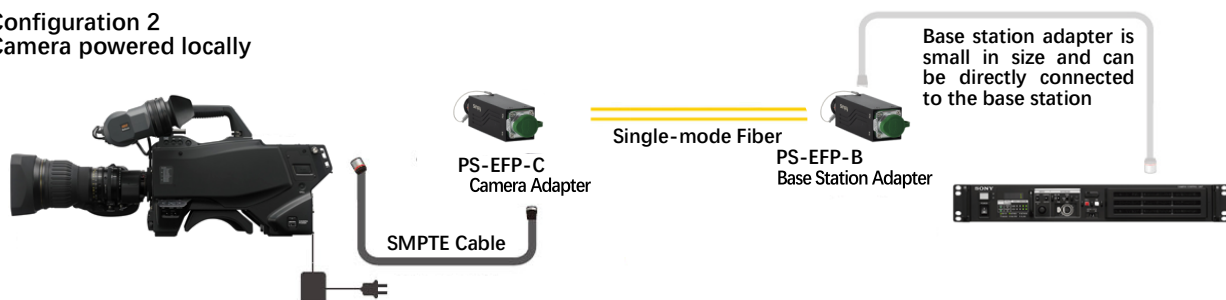

System Configuration

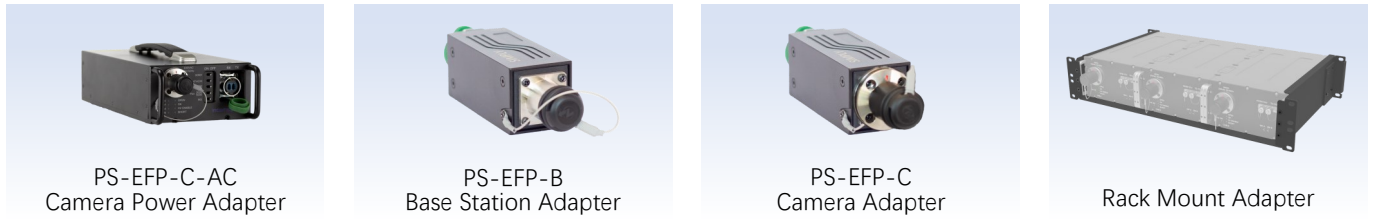

Technical Specifications

General	
Dimension / Weight	PS-EFP-C-AC: 272×145×85mm, Approx. 4.5kg PS-EFP-B: 150×40×40mm, Approx. 0.6kg PS-EFP-C: 154×40×40mm, Approx. 0.6kg
Operating temperature	-20°C to +70°C
Operating humidity	0 to 95%
Power consumption	AC 220/110V±10%, 50/60Hz, 25W (PS-EFP-C-AC)
Power Output	260W (Max)
Connectors	
Hybrid optic	SMPTE 304M, optional Tajimi OPS)
Single-mode optic	LC, optional ST, FC, SC
Carrier Signal	
Camera side	Camera to CCU: Video, Audio (Mic/Line), Intercom
CCU side	CCU to Camera: Return video, Promoter video, Audio (PGM), Intercom
Compatible Model	
Model	SONY: HDC-1580, HDC-2580, HDC-4300, HDC-4800, HDC-3500, HDC-5500 Panasonic: AK-HC3500, AK-HC3800, AK-HC5000, AK-UC4000 Ikegami: all HDK series SMPTE interface Broadcast Camera Hitachi: all CH-HD series, SK-HD series SMPTE interface Broadcast Camera

Dimensions

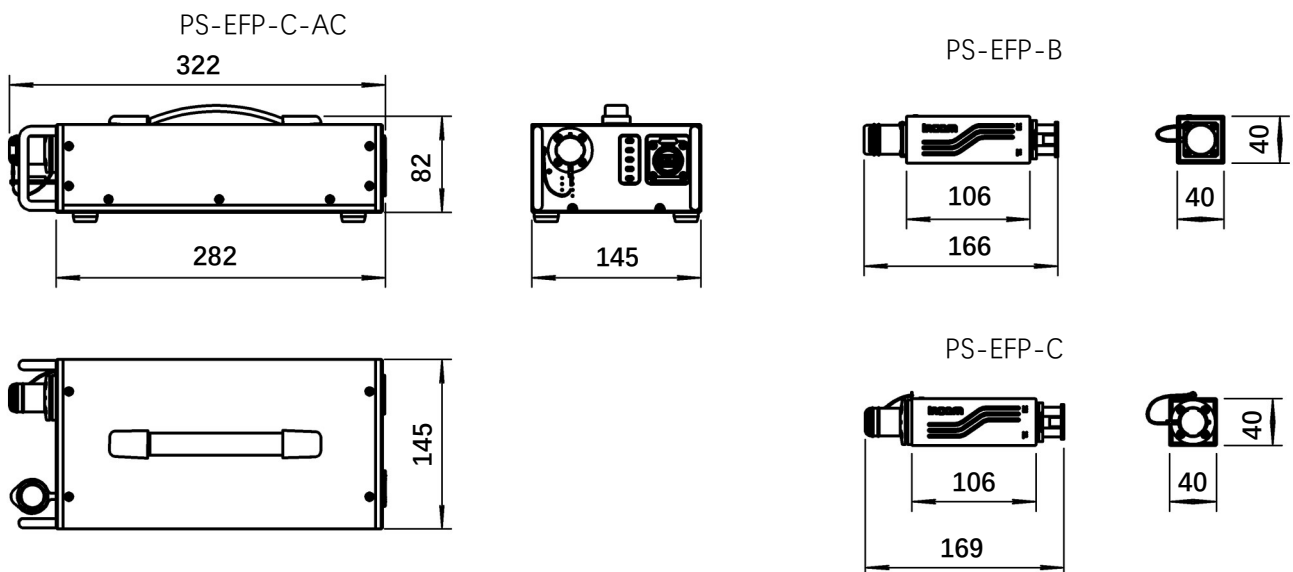

Design and specifications are subject to change without notice.

INCAM Systems Co., Ltd.

Building B6, North Park, No.315 Xiqing Road, Yangliuqing Town, Xiqing District, Tianjin, China

